

2007

Alloy Steel

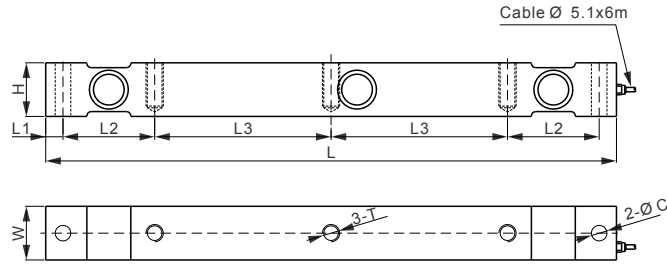

** NOTE : Not all approvals are available on all models.
Please request a certified drawing if specific approvals are required.

DIMENSIONS

RATED CAPACITY	C	H	L	L1	L2	L3	W	T
kg/mm								
25,000	18.0	62.0	660	20.0	106	204	62.0	M20 Depth35
lb/inches (conversion of above dimensions)								
55,115	0.71	2.44	26.0	0.79	4.17	8.03	2.44	M20 Depth1.38

SPECIFICATIONS

Rated Capacity	t	25
Weight (G), approx.	kg/lb	19 / 43
Full Scale Output	mV/V	2.0±0.25%
Zero Balance	mV/V	±0.06
Non-linearity	%	<±0.030
Repeatability	%	<±0.017
Hysteresis Error	%	<±0.023
Creep in 30 min.	%	<±0.023
Bridge Resistance	Ω	700±10
Rated Excitation	V(DC/AC)	10 (15V Maximum)
Insulation Resistance	GΩ	>2[50 VDC]
Nominal Temperature Range	°C/°F	-10 to 40 / 14 to 104
Safe Overload	% of full scale	150
Breaking Overload	% of full scale	300
Seal Type		Glue-sealed, IP67

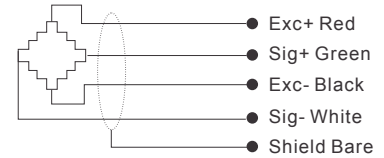

AVAILABLE OPTIONS

Service temperature range up to 120°C [248°F]
6-wire circuit
Other capacities and imperial thread holes are available upon request

DOUBLE ENDED BEAMS