

# 5002

## Alloy Steel

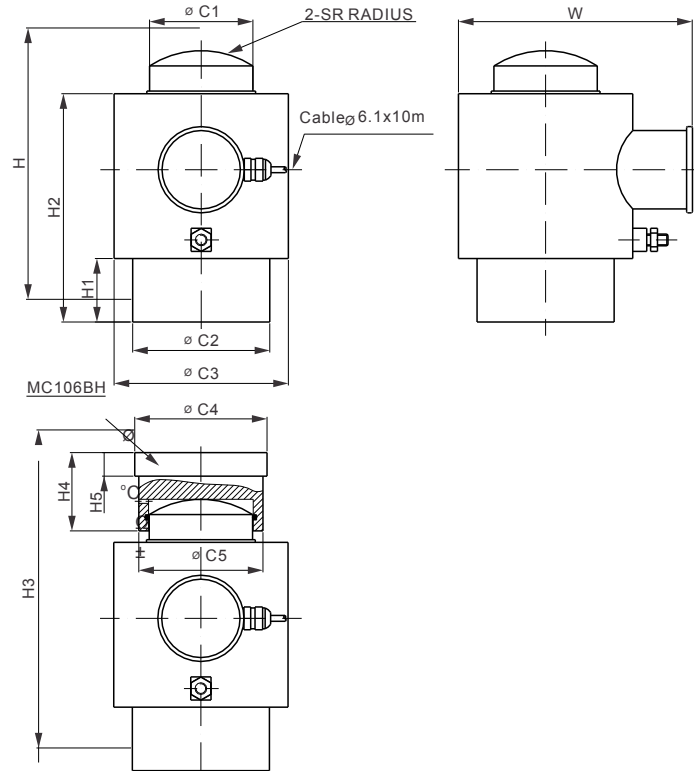

**DIMENSIONS**



\*\* NOTE : Not all approvals are available on all models. Please request a certified drawing if specific approvals are required.

Mounting hardware to be ordered separately.

**RATED**

<b>CAPACITY</b>	<b>C1</b>	<b>C2</b>	<b>C3</b>	<b>C4</b>	<b>C5</b>	<b>H</b>	<b>H1</b>	<b>H2</b>	<b>H3</b>	<b>H4</b>	<b>H5</b>	<b>SR</b>	<b>W</b>
<b>kg/mm</b>													
100,000	59.0	95.0	155.0	84.0	72.0	185.0	20.0	167.0	224.0	50.0	15.0	380.0	191.0
200,000	85.0	125.0	166.0	120.0	104.0	258.0	39.0	233.0	300.0	60.0	20.0	450.0	202.0
500,000	127.0	180.0	268.0	175.0	160.0	365.0	35.0	325.0	425.0	85.0	20.0	506.0	329.0
<b>lb/inches</b> (conversion of above dimensions)													
220,462.3	2.32	3.74	6.10	3.31	2.83	7.28	0.79	6.57	12.76	1.97	0.59	14.96	7.52
440,924.5	3.35	4.92	6.54	4.72	4.09	10.16	1.54	9.17	11.81	2.36	0.79	17.72	7.95
1,102,311.3	5.00	7.09	10.55	6.89	6.30	14.37	1.38	12.80	16.73	3.35	0.79	19.92	12.95

**SPECIFICATIONS**

<b>Rated Capacity</b>	t	100	200	500
<b>Weight (G), approx.</b>	kg/lb	9 / 21	20 / 43	77 / 170
<b>Full Scale Output</b>	mV/V	2±20%		
<b>Zero Balance</b>	mV/V	±0.05		
<b>Non-linearity</b>	%	<±0.050		
<b>Repeatability</b>	%	<±0.017		
<b>Hysteresis error</b>	%	<±0.017		
<b>Creep in 30 min.</b>	%	<±0.023		
<b>Bridge Resistance</b>	Ω	700±5		
<b>Rated Excitation</b>	V(DC/AC)	10 (15V Maximum)		
<b>Insulation Resistance</b>	GΩ	>2[50 VDC]		
<b>Nominal Temperature Range</b>	°C/°F	-10 to 40 / 14 to 104		
<b>Safe Overload</b>	% of full scale	150		
<b>Breaking Overload</b>	% of full scale	300		
<b>Seal Type</b>		Environmentally-sealed, IP67		

- Exc+ Red
- Sig+ Green
- Exc- Black
- Sig- White
- Shield Bare

**AVAILABLE OPTIONS**

- Service temperature range up to 120°C[248°F]
- Lightning protection
- Dual bridge system for double reliability