

The 7001 Load Pin Series are designed for tension and compression measurements. They can be applied on clevis pin shackles and crane scales.



### FEATURES

- Stainless steel construction.
- Rated Capacities from 20t to 70t.
- IP Rating: IP67

### APPLICATIONS

- Crane scale, Clevis pin.

### OPTIONS

- Service temperature range up to 120°C [248°F].
- Lightning protection.
- Tailor made for different application.

### OUTLINE DIMENSIONS

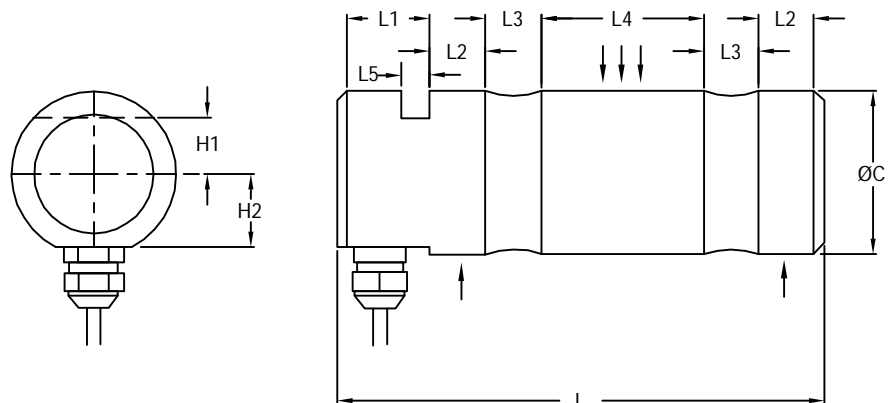

Rated Capacity(kg)	C	H1	H2	L	L1	L2	L3	L4	L5
2000-5000	1.38 [35.0]	0.45 [11.5]	0.63 [16.0]	4.13 [105.0]	0.79 [20.0]	0.47 [12.0]	0.47 [12.0]	1.38 [35.0]	0.25 [6.30]
10000	1.97 [50.0]	0.79 [20.0]	0.89 [22.5]	5.98 [152.0]	1.18 [30.0]	0.71 [18.0]	0.71 [18.0]	1.89 [48.0]	0.41 [10.5]
20000	2.56 [65.0]	0.89 [22.5]	1.12 [28.5]	7.48 [190.0]	1.26 [32.0]	0.79 [20.0]	0.98 [25.0]	2.56 [65.0]	0.41 [10.5]
40000	3.35 [85.0]	0.89 [22.5]	1.12 [28.5]	10.08 [256.0]	1.42 [36.0]	1.38 [35.0]	1.10 [28.0]	3.50 [89.0]	0.49 [12.5]
70000	3.94 [100.0]	1.34 [34.0]	1.38 [35.0]	12.91 [328.0]	1.57 [40.0]	1.97 [50.0]	1.26 [32.0]	4.72 [120.0]	0.59 [15.0]

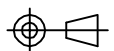

# load pin 7001



## WIRING

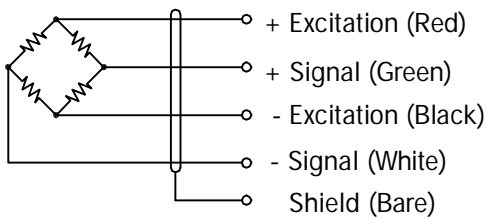

Cable : Ø5.1mm diameter, 4 conductor shielded cable.

## SPECIFICATIONS

Model	7001	
Capacities	t	2/ 5/ 10/ 20/40/ 70
Full Scale Output (FS)	mV/V	1.0±10%
Non-Linearity	%FS	≤±0.5
Hysteresis	%FS	≤±0.5
Non- Repeatability	%FS	≤±0.3
Creep @ 30min	%FS	≤±0.20
Zero Balance	mV/V	±0.05
Temperature Range	°C	-10... +40
Bridge Resistance	Ω	350±3
Excitation Voltage	VDC	10... 15
Insulation Resistance @ 50V DC	MΩ	≥2000
Safe Overload Limit	%FS	200
Ultimate Load	%FS	400
Cable Length	m	3
Seal Type	IP67	
Element Material	Stainless steel	

Dimensions and specifications subject to change without notice