

The type TLLC is a tension link load cell. Ideal for use in crane scales & tension measurements.

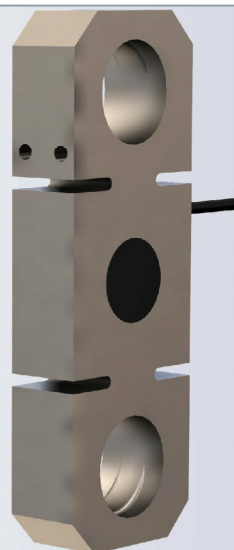

FEATURES

- Capacities from 1t to 120t.
- Alloy steel construction.
- Environmental Protection IP67.
- Small size, low profile.

APPLICATIONS

- Crane scales, tension measurement.

OPTIONS

- Stainless steel version.

OUTLINE DIMENSIONS

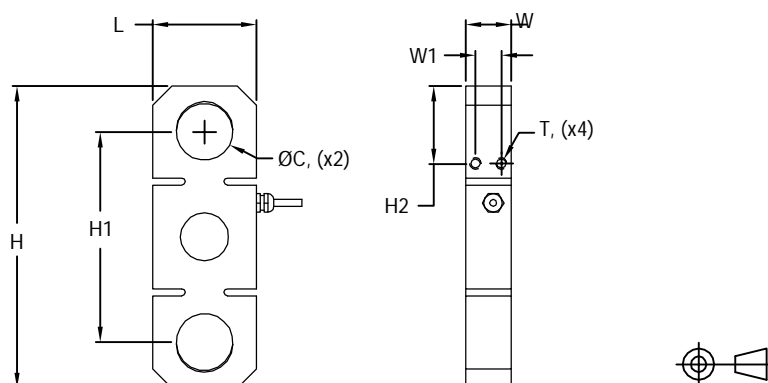

Capacity(kg)	C	H	H1	H2	L	W	W1	T
1000	0.59 [15.0]	3.15 [80.0]	2.19 [55.5]	0.81 [20.5]	1.08 [27.4]	0.47 [12.0]	0.28 [7.0]	M3, 0.2[5.0]DP.
2000	0.79 [20.0]	4.49 [114.0]	3.15 [80.0]	1.20 [30.5]	1.38 [35.0]	0.59 [15.0]	0.31 [8.0]	M3, 0.2[5.0]DP.
5000	1.06 [27.0]	5.51 [140.0]	3.66 [93.0]	1.61 [41.0]	1.50 [38.0]	0.98 [25.0]	0.59 [15.0]	M6, 0.24[6.0]DP.
10000	1.46 [37.0]	7.20 [183.0]	4.72 [120.0]	2.24 [57.0]	2.17 [55.0]	1.34 [34.0]	0.87 [22.0]	M6, 0.31[8.0]DP.
20000	2.09 [53.0]	9.92 [252.0]	6.46 [164.0]	3.23 [82.0]	2.91 [74.0]	1.97 [50.0]	1.18 [30.0]	M6, 0.31[8.0]DP.
30000	2.36 [60.0]	12.11 [307.5]	7.95 [202.0]	3.66 [93.0]	3.39 [86.0]	2.36 [60.0]	1.57 [40.0]	M8, 0.47[12.0]DP.
50000	2.87 [73.0]	15.35 [390.0]	10.12 [257.0]	4.57 [116.0]	4.33 [110.0]	2.95 [75.0]	1.57 [40.0]	M12, 0.79[20.0]DP.
75000	3.46 [88.0]	19.13 [486.0]	12.76 [324.0]	5.79 [147.0]	5.31 [135.0]	3.54 [90.0]	2.36 [60.0]	M12, 0.79[20.0]DP.
100000	4.02 [102.0]	22.83 [580.0]	15.31 [389.0]	6.77 [172.0]	6.30 [160.0]	3.94 [100.0]	2.36 [60.0]	M12, 0.79[20.0]DP.
120000	4.02 [102.0]	22.83 [580.0]	15.31 [389.0]	6.77 [172.0]	6.30 [160.0]	4.72 [120.0]	2.36 [60.0]	M12, 0.79[20.0]DP.

tension link
TLLC
9001

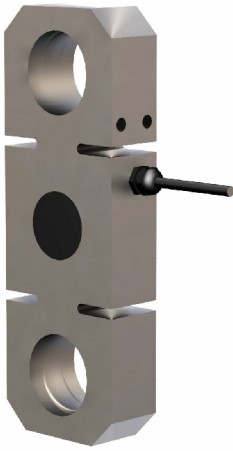

WIRING

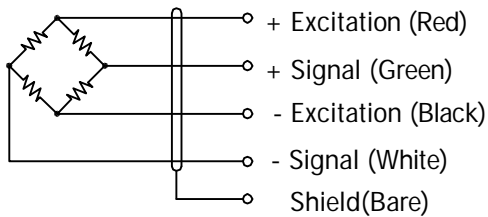

Cable : Ø5.0mm , 4 Conductor cable.

SPECIFICATIONS

Model	TLLC		
Accuracy class	C3		
Capacities	t	1/ 2/ 5/ 10/ 20/ 30/ 50/ 75/ 100/ 120	
Full scale output(FS)	mV/V	3±10%	
Non-linearity	%FS	≤±0.017	
Hysteresis	%FS	≤±0.017	
Non- repeatability	%FS	≤±0.017	
Creep@30min	%FS	≤±0.023	
Zero Balance	mV/V	±0.05	
Temperature range			
	Operating	°C	-10... +40
Bridge resistance	Ω	350±3	
Excitation voltage	V(DC/AC)	12(18Max.)	
Insulation resistance@50VDC	MΩ	≥2000	
Safe overload limit	%FS	200	
Ultimate load	%FS	400	
Cable length	m	6 (<20t)	
		10 (≥20t)	
Seal type	IP67		
Element material	Alloy steel		

Dimensions and specifications subject to change without notice