

The G4610 is a full-featured multipurpose, easy-to-use digital strain gauge & load cell meter ideal for weight and force measurement applications.



FEATURES

1 0 1 0 00 r
 1 2 1 0 2 0 r
 r 10 r
 M r 12 0 Ω d
 d 2 Ω
 r r r r r r
 r r r r
 r r
 M M r d r
 r 0 0" 04 "
 r
 d 1 2 1 0 2 0 0 r 100
 r r
 2 r
 M 4 r
 r d 2 r 12 24
 2 r 4 d 4 20
 r 4 M d
 2 2 4 r
 M d r d rd
 r M r r r

OUTLINE DIMENSIONS

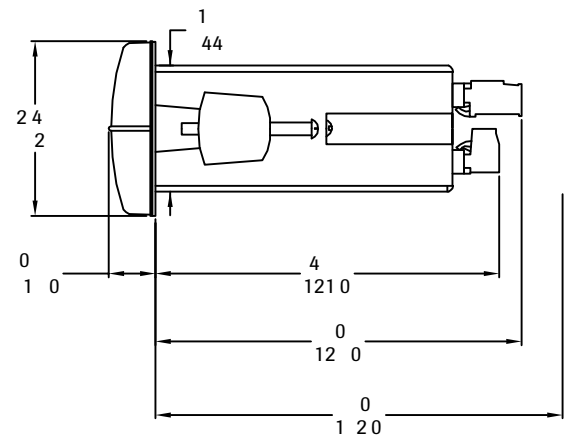
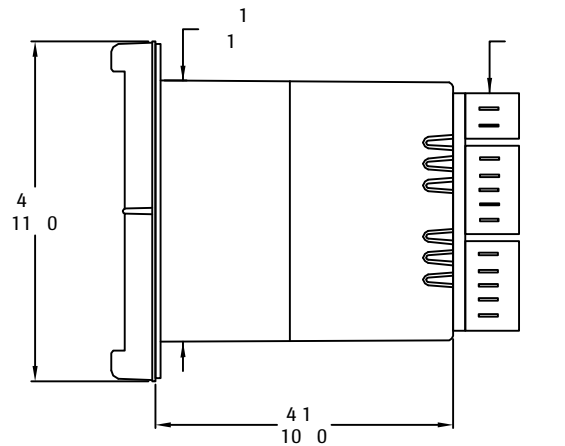

1 r r d 1 2" 22" 4 2
 2 0 040 0 2 0" 10 4
 M r r
 4 r " 1 2 d

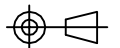

Strain Gauge, Load Cell & mV Meter G4610

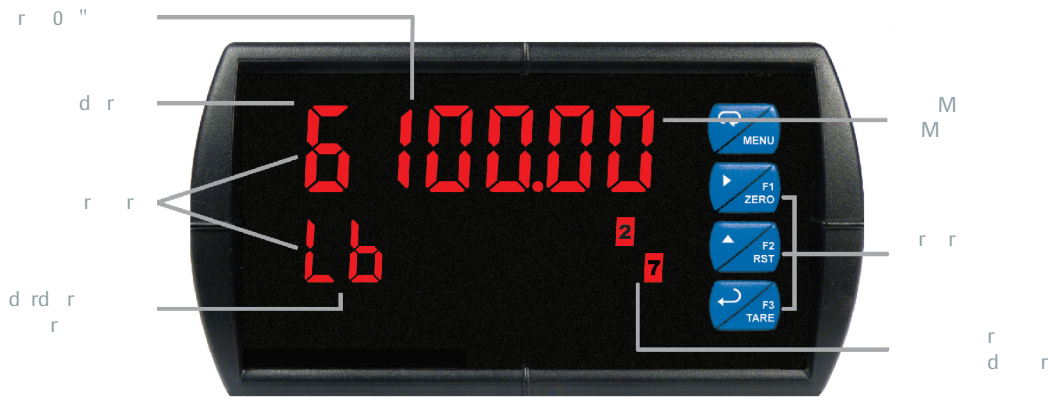

KEY FEATURES

Precise, Accurate, and More Informative

High resolution 24 bit ADC, 0.001% accuracy, 10000 counts

Configurable

Weight, mV, Net, Gross, Tare, Max, Peak, Units, and more. Configurable via menu keys.

Function Keys

Menu, Zero, Reset, Tare, and Hold keys for easy operation.

Rugged

IP65 rated, shock resistant, and designed for industrial environments.

Optional SunBright Display Models

Available with high-contrast SunBright display for outdoor use.

On-Board Digital Input

Supports digital input for integration with other systems.



UV Resistant Sunlight Readable Models
Front Panel NEMA 4X Rated

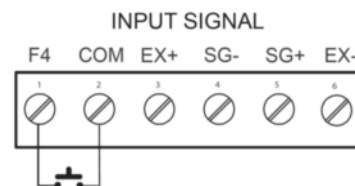

Zero the Meter

r r d r r dr r r r d r r
 d r dr d r d r r r d r r r
 r r d r r r rd rr r d r

Capture Tare

r r d r d d r d r r d
 r d r d r r r d r r d
 r d r r r d r d



Before tare

After capture tare

After reset tare

Automatic Unit Conversion

dd r r r d d r d d r
 r r r r d r d d d
 d r dd r r r d rd d 100 0 4
 4 2 1 00

Auto-Zero

r r rr r dr r r r r
 r d r d d r d r r
 r r

Rounding

r d r d r d r d rd d r d
 r rd r d d 1 2 10 20 0 r 100 r r d
 10 d 12 4 d d d 12 0

Shunt Calibration Check

4 10 d r r rd r d d r r
 r d r r r d 0 d
 0Ω r rd

Ratiometric Compensation

r r r r d r r r r

Dual-Scale Display Feature

4 10 r r d r d d d d r r
 r d d r r r r r d 4 20 d
 d r r r r d r d r



Volume & Height

Pressure & mV

Advanced Linearization Capability

d 2 r r r r d d d d r r
 r d d d 2 d r d r M r d
 r r r r r d r d r

Strain Gauge, Load Cell & mV Meter

G4610

DIGITAL COMMUNICATIONS

Modbus® RTU Serial Communications

d r r r M d d r 4 10 r d d r 4 10 M d M r
 r r r M d r d r r r d d r 4 10 r r
 r r r d 4 10 M d
 d r r r d
 r d 4 20 d r
 r r r d r
 M d d
 r r d r r d
 r r d



Modbus PV Input Remote Message

Meter Copy

r d r r 4 10 r 4 10 r 20 d !
 d rd r r r d r r
 1200 r r r d



FIELD EXPANSION MODULES

dd 4 10 d r d dd 2 2 r 4
 d d 2 d 4 r d r d d
 d d r r rd



METERVIEW® PRO SOFTWARE

r r dd 4 10 r r r M r r r

OUTPUTS

Relay Outputs

4 10 r r r r d r r d r d
 r r r r r d r r r d r d
 d r r d r r r r d r 0 100 d d d

Group Four Transducers

22 r r r
 d M 0102
 r r r d r

(800) 419 1444
 41 2 1 2
 r 4

Relay Operation/Configuration

r r r r r d 4 10 r r d
 r
 r
 r r r r d r d
 r r r
 d r r d
 r r
 r r 4 20
 d d d d r r
 M r d
 r r d

Analog Output

d r r r d r r r r
 4 20 r d d r d r r r M d
 r 1 2

Manual Output Control

r r r r d 4 20
 d r r r d 4 20 r r d d M r d
 d d r 1 r 10 d d r r d

Isolated Transmitter Power Supplies

r d r d rd r 4 10 r r d r 10 d r 24
 d r r d
 24 40 d rd 4 20 dd r

CONNECTIONS

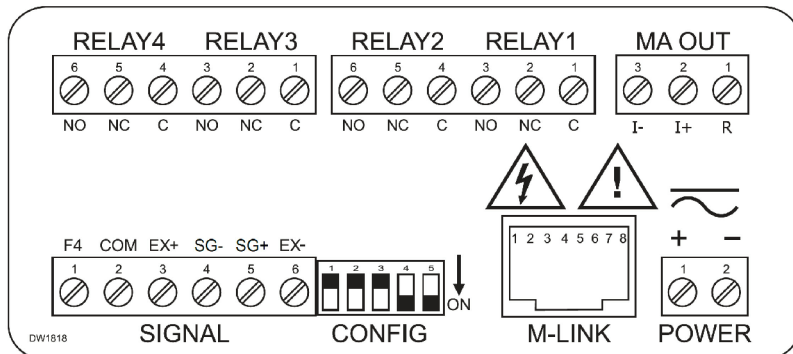

Strain Gauge, Load Cell & mV Meter

G4610

SPECIFICATIONS

M d	4 10
General	
	r d 0 0" 1 r d 0 4 " 12 r d r d
d	d 200
rr	
d rr	
	d r d d 1 2 M d d d
	r r
r	M 4
r r M d	r r d d M r r r M d r r r
4	r r 4 M
4	0 12
r	r r r 2 1 0 d r
r	r r r 01 r d
d	1 2 10 20 0 r 100 r d 10 12 4 d 12 0
r	r r r d r r r d d r 12
M M	M r d r d r r r d
rd	r r r rd r r d r r d
M r	r r d r r d r r r r
r	2 0 0 0 2 20 r r 12 24 10 1
	r d r d r
d r r r	10 12 24 r d d 10 r 24 d d r r d 10 r r 4 4 10 2 d r d 200 12 24 r d d r d 100 0 r r 10 24 r r rd
r M d	r r 0 d 0 0
	4 r 00 r d r
r r	r r r r r r
r	r 4 10 r r r 40 r r r 40 d 0 0 d
	r r 12 22 r 4 r r r d d r d r
r	1 4 0 r
M	1 r r d 22" 1 2" 2 4 r r r d d
r	r r r 0
	4 " 2 4 " 4" 11 2 14
	2
rr	r

SPECIFICATIONS

Strain Gauge Input	
	d 0 1 0 0 0 1 0 0 00 1 2 1 0 2 0 rM d
r	00 r d 1
M d	2 Ω r10
M rr	0 r10
r r r	0002 r d r 0 000 r d r 0 0
	r r
	0 0 d
	d r d d d d d d d d d d d d d d d d r d d d d d
	M 1 2
r	1 02 2 0 04 1 0 20 2 0 00 40 rr r r 1 d 2 r r
d	r r r 1 M Ω
Relays	
	r d 0 2 r4 r r d r4 r r d d d
r	r r d d r r d d
d d	0 100 r r r
r r	r r r r r d r d r d d r d
r	r d r d d r r d r d r 2
	r r rd
	1 r r
	2 r
	M r
	4 M r r d rd rd r r r d r r
	0 d r d r r d d d r r
r	r r r d d d r r r r r
	r d r r r
	r d r r r
Serial Communications	
r	M d
	1 24 M r d d r
d	00 1 200
r	r r 0 d 1 r r r r 422
	1 r 1 r 2
r	d d r 1 r 2
	001 2 4 d
r r d	2 d

Strain Gauge, Load Cell & mV Meter

G4610

SPECIFICATIONS

Isolated 4-20 mA Transmitter Output	
1	1000 2 000 r d r
2	r r d 0 00 1000 4 20
3	1 000 d 2 000 r r r rr d rr d r
4	0 1 0 004
5	0 4 μ r 0 0 μ r r 40 0 dr
6	M d r 4 20 24 10 r rd d
7	4 10 d r d 40
8	
9	r M M 24 10 Ω 00 Ω r 100 Ω 1200 Ω
Digital I/O Expansion Module	
10	4 d 4 d r d
11	2 d r
12	0 12
13	1 0 04
14	10
15	1
16	d rd
4-Relay Expansion Module	
17	r r r d 0 d 12 2 0 r d 114 ≈ 0 12 2 0 rd d
18	r d r 2

PART NUMBERS

Standard Models		SunBright Display Models		Options Installed
85-265 VAC Model	12/24 VDC Model	85-265 VAC Model	12/24 VDC Model	
4 10 0	4 10 0	4 10 0	4 10 0	
4 10 2	4 10 2	4 10 2	4 10 2	2
4 10	4 10	4 10	4 10	4 20
4 10 4	4 10 4	4 10 4	4 10 4	4
4 10	4 10	4 10	4 10	2 4 20
4 10	4 10	4 10	4 10	4 4 20

ACCESSORIES

Model	Description
1002	M r M d
1004	4 M d
1044	4 4 M d
1200	M r
12 2	2 2 r d r
14	422 4 r d r

Model	Description
4	2 2 422 4 d r r
4	2 2 422 4 d r r
00	r d r
2 2	2 2 d r r
4	422 4 d r r
4	422 4 d r r
01	r r r 001 μ 4 0 Ω 2 0

d



Group Four Transducers
22 r r r
d M 0102
r r r d r

(800) 419 1444
41 2 1 2
r 4