

The type TLLC is a tension link load cell. Ideal for use in crane scales & tension measurements.

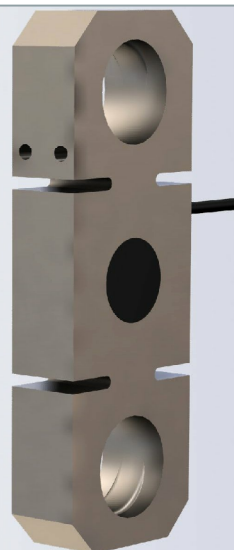

FEATURES

- Capacities from 1t to 120t.
- Alloy steel construction.
- Environmental Protection IP67.
- Small size, low profile.

APPLICATIONS

- Crane scales, tension measurement.

OPTIONS

- Stainless steel version.

OUTLINE DIMENSIONS

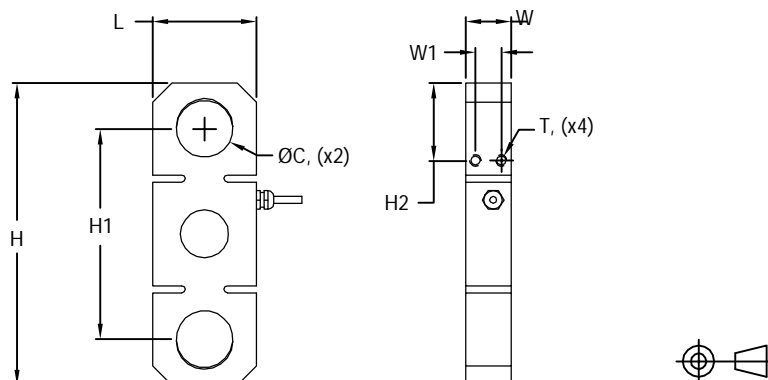

Capacity(kg)	C	H	H1	H2	L	W	W1	T
1000	0.59 [15.0]	3.15 [80.0]	2.19 [55.5]	0.81 [20.5]	1.08 [27.4]	0.47 [12.0]	0.28 [7.0]	M3, 0.2[5.0]DP.
2000	0.79 [20.0]	4.49 [114.0]	3.15 [80.0]	1.20 [30.5]	1.38 [35.0]	0.59 [15.0]	0.31 [8.0]	M3, 0.2[5.0]DP.
5000	1.06 [27.0]	5.51 [140.0]	3.66 [93.0]	1.61 [41.0]	1.50 [38.0]	0.98 [25.0]	0.59 [15.0]	M6, 0.24[6.0]DP.
10000	1.46 [37.0]	7.20 [183.0]	4.72 [120.0]	2.24 [57.0]	2.17 [55.0]	1.34 [34.0]	0.87 [22.0]	M6, 0.31[8.0]DP.
20000	2.09 [53.0]	9.92 [252.0]	6.46 [164.0]	3.23 [82.0]	2.91 [74.0]	1.97 [50.0]	1.18 [30.0]	M6, 0.31[8.0]DP.
30000	2.36 [60.0]	12.11 [307.5]	7.95 [202.0]	3.66 [93.0]	3.39 [86.0]	2.36 [60.0]	1.57 [40.0]	M8, 0.47[12.0]DP.
50000	2.87 [73.0]	15.35 [390.0]	10.12 [257.0]	4.57 [116.0]	4.33 [110.0]	2.95 [75.0]	1.57 [40.0]	M12, 0.79[20.0]DP.
75000	3.46 [88.0]	19.13 [486.0]	12.76 [324.0]	5.79 [147.0]	5.31 [135.0]	3.54 [90.0]	2.36 [60.0]	M12, 0.79[20.0]DP.
100000	4.02 [102.0]	22.83 [580.0]	15.31 [389.0]	6.77 [172.0]	6.30 [160.0]	3.94 [100.0]	2.36 [60.0]	M12, 0.79[20.0]DP.
120000	4.02 [102.0]	22.83 [580.0]	15.31 [389.0]	6.77 [172.0]	6.30 [160.0]	4.72 [120.0]	2.36 [60.0]	M12, 0.79[20.0]DP.

tension link
TLLC
9001

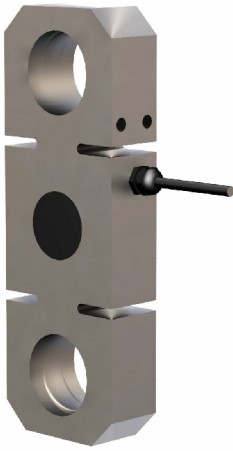

WIRING

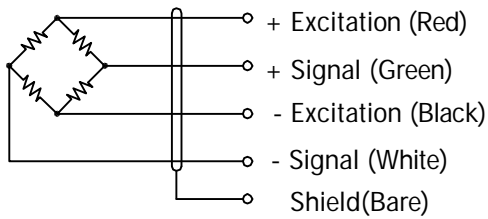

Cable : Ø5.0mm , 4 Conductor cable.

SPECIFICATIONS

Model	TLLC		
Accuracy class	C3		
Capacities	t	1/ 2/ 5/ 10/ 20/ 30/ 50/ 75/ 100/ 120	
Full scale output(FS)	mV/V	3±10%	
Non-linearity	%FS	≤±0.017	
Hysteresis	%FS	≤±0.017	
Non- repeatability	%FS	≤±0.017	
Creep@30min	%FS	≤±0.023	
Zero Balance	mV/V	±0.05	
Temperature range			
	Operating	°C	-10... +40
Bridge resistance	Ω	350±3	
Excitation voltage	V(DC/AC)	12(18Max.)	
Insulation resistance@50VDC	MΩ	≥2000	
Safe overload limit	%FS	200	
Ultimate load	%FS	400	
Cable length	m	6 (<20t)	
		10 (≥20t)	
Seal type	IP67		
Element material	Alloy steel		

Dimensions and specifications subject to change without notice



Pioneering Measured Solutions

Group Four Transducers
 22 Deer Park Drive,
 E. Longmeadow, MA 01028
 www.groupfourtransducers.com

Phone : (800) 419 1444
 Fax : (413) 525 -6182
 sales@group-4.com