

The type GBLZ is a stainless steel button type load cell for force and weight measurement.



FEATURES

- Capacities 750lb and 1000lb.
- Stainless steel construction.
- Environmental protection IP67.

APPLICATIONS

- Force and weight measurement.

OUTLINE DIMENSIONS

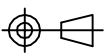
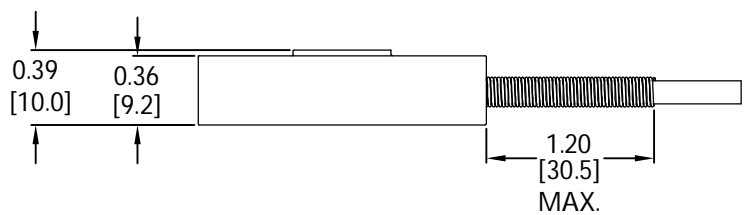
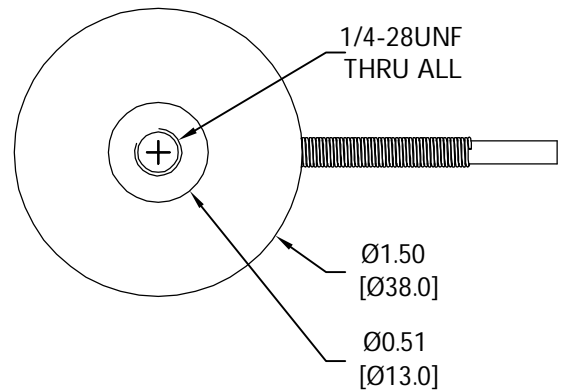

load button
GBLZ
5034



WIRING

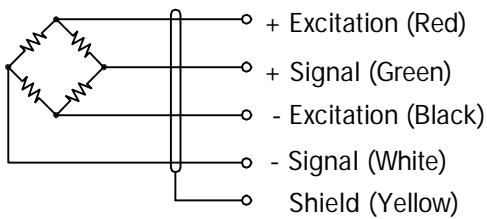

Cable : 28AWG, 4 conductor gray cable with shield.

SPECIFICATIONS

Model	GBLZ		
Capacities	lb	SEE TABLE	
Full Scale Output (FS)	mV/V	2.0±0.1	
Non-Linearity	%FS	≤±2	
Hysteresis	%FS	≤±2	
Non- Repeatability	%FS	≤±2	
Creep @ 30min	%FS	≤±2	
Zero Balance	%FS	≤±2	
Temperature Effect			
	Zero	%FS/10°C	≤±0.07
Temperature Range			
	Compensated	°C	-40... +65
	Operating	°C	-50... +75
Terminal Resistance			
	Input Resistance	Ω	380±50
	Output Resistance	Ω	350±5
Excitation Voltage	VDC	10... 15	
Insulation Resistance @ 50V DC	MΩ	≥5000	
Safe Overload Limit	%FS	150	
Ultimate Load	%FS	300	
Cable Length	in	68	
Seal Type	IP67		
Element Material	Stainless steel		

PART NUMBERS

Capacity (lb)	Part#
750	5034-001-00
1000	5034-002-00

Dimensions and specifications subject to change without notice