

Group Four offers away an innovative way to measure temperature with the GTP 8000, all stainless steel construction, low profile temperature probe. Standard range of 0-200 deg C. Available outputs for 4-20 mA and 1-5 Vdc.



FEATURES

- All stainless steel construction
- Low profile temperature probe
- Output: 4-20 mADC, 1-5 VDC
- Standard range: 0 - 200 °C
- Custom designs available¹

DIMENSIONS

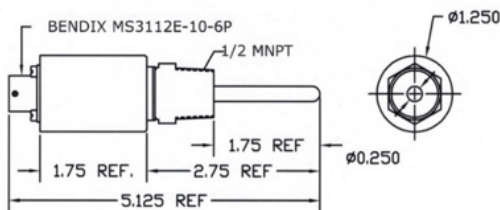

ORDERING GUIDE

C	(0-200)	1.75	D	EC1
PRESSURE PORT	RANGE ²	INSERTION LENGTH ³	PRESSURE OUTPUT	CONNECTOR
C = 1/2" MNPT	°C / °F	IN/MM	D = 4-20mA	EC1 = 36" PIGTAIL ²
			E = 1-5 VDC	EC2 = LARGE DIN 43650, FORM A
				EC3 = MINI DIN 43650, FORM C
				EC4 = BENDIX PTIH-10-6P
				ECX = OTHER

PERFORMANCE @ 25° CAccuracy: $<\pm 0.3$ °C OF READINGStability: (2 year): $<\pm 0.05\%$ FS, TYPICALResponse: < 5 ms TO 90%**ENVIRONMENTAL DATA**

Temperature

Storage: -50°C to 125°C

Thermal Limits

Compensated Range: 1°C to 38°C

Thermal Effect Zero: $\leq \pm 0.50\%$ FSThermal Effect Span: $\leq \pm 0.50\%$ FS**PHYSICAL DATA**

Sensor

Wetted Material: 316 SS

Material: 316 SS

ELECTRICAL DATA

Excitation: 9-36 VDC (4-20 mA, 1-5 VDC)

Current Consumption: < 5 mAOutput Load: $>10K \Omega$

1 CONTACT FACTORY

2 SPECIFY TEMPERATURE RANGE IN °C OR °F

3 SPECIFY LENGTH OF PROBE IN INCHES OR MILLIMETERS