

The digital single point load cell type GVSD is a special low capacity, low form factor single point load cell useful in force measurement and industrial applications. Special bracket and spacers provide ease of installation and accuracy.

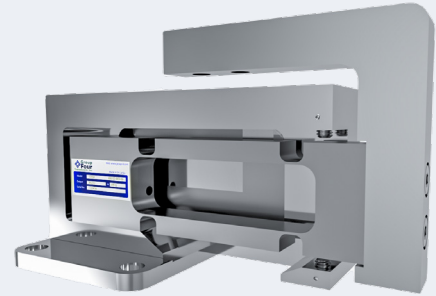

### FEATURES

- Capacity: 200, 500 & 1000 grams
- Anodized aluminum construction
- Environmental protection IP67
- Low profile design
- Special bracket & spacers

### APPLICATIONS

- Low capacity force measurement
- Special applications in medical
- Jewelry scales

### OUTLINE DIMENSIONS

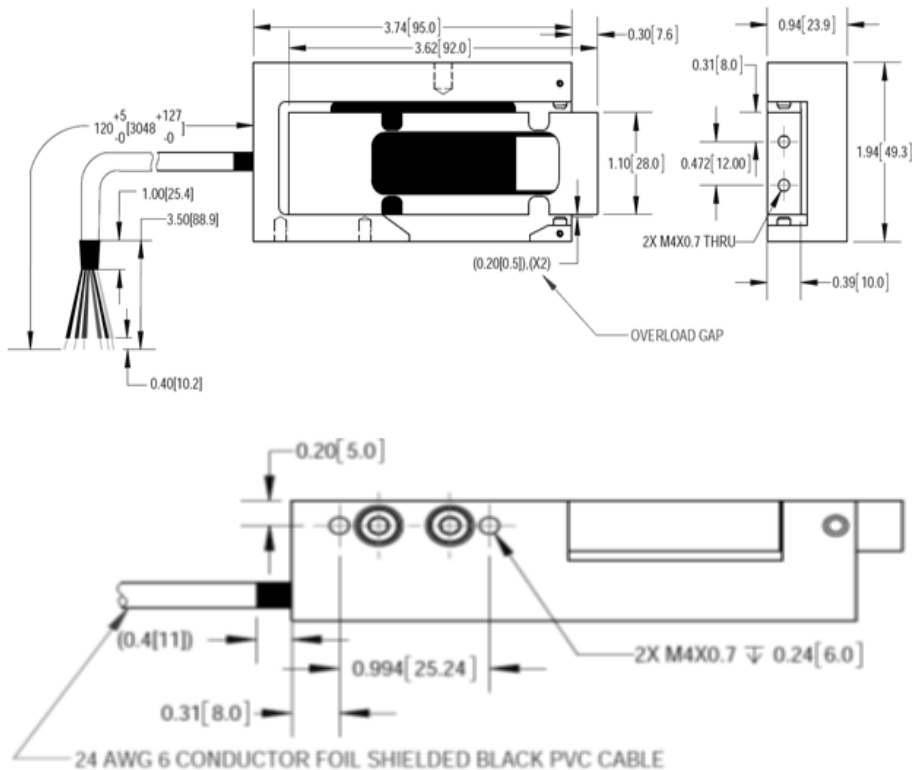

## Load Cell Without Spacer and Universal Bracket

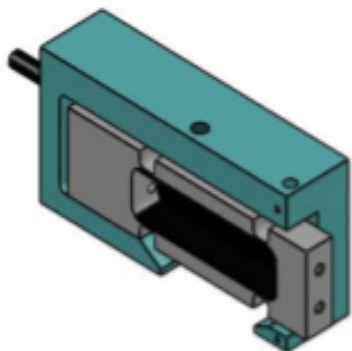

## Load Cell With Spacer and Universal Bracket

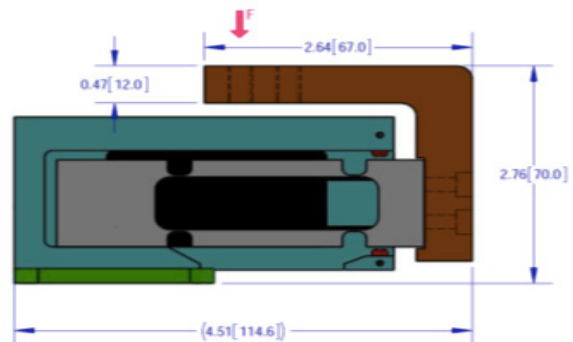
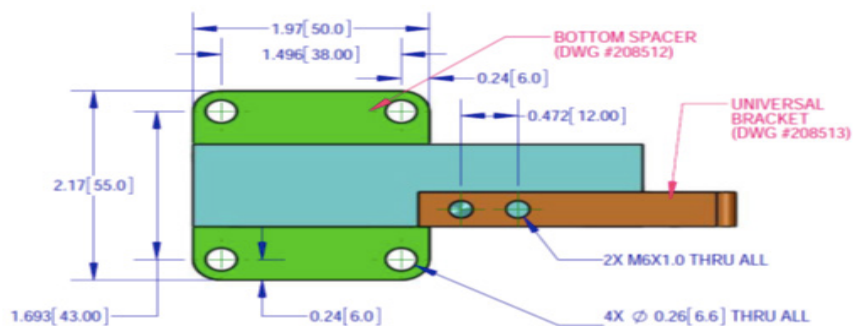

## SPECIFICATIONS

Model	GVSD			
Capacity (E max)	g	200	500	1000
<b>PERFORMANCES</b>				
Combined Error	%FS	±0.1		
Creep Error (30 min)	%FS	±0.1		
Zero Balance, Raw Counts	Increments	See note 6		
Output resolution at full load, raw counts	Increments	256000	512000	512000
Internal AD conversion rate	upd./sec	1200		
Fix, digital low pas IIR filter, default	Hz	18 (Suppress 50Hz and 60 Hz influence)		
Adjustable, digital low pass IIR filter	Hz	18-0.25; selectable in 8 steps		
Adjustable, digital low pass FIR filter		40-5, selectable in 8 steps		
Adjustable, external output update rate	upd./sec	1200-9; selectable in 8 steps		
<b>GENERAL I/O's</b>				
Hardware interface, CAN version		CAN and RS232 RS485 and RS422 (both 4 wire)		
Hardware interface, RS version				
Data transmission rate CAN	kb	125; 250; 500; 1000		
Data transm, rates RS485/RS422/RS232		9.6; 19.2; 38.4; 57.6; 115.2; 230.4; 460.8		
Protocol CAN		CANopen		
Protocol RS485/RS422/RS232		ASCII or Modbus RTU		
Logical input, programmable		Trigger level 2-30Vdc, <3mA, Ref to Gnd		
Power supply	VDC	+10 -+30<0.4 Watt		
<b>INFLUENCES</b>				
Safe load limit	%FS	150		
Ultimate load	%FS	300		
Eccentric loading error acc. to OIML R76	%FS	±0.02		
Max platform size	mm	200x200		
Temperature effect on zero	%FS/10°C	±0.04		
Temperature effect on span	%FS/10°C	±0.12		
Temperature range	°C	Operating: -10/+40		
EMC performance		MID Class E2 (industrial locations)		
I/O protection, all pins		Reversed polarity; excess voltage and surge		
Isolation body/electronics at 500VDC	G	>1		
Vibration		2.5G operational; 5G non-operational		
Environmental protection per IEC 529		IP67		
Corrosion resistance		Anodized Aluminum		