

The type GBL is a stainless steel button type load cell for force and weight measurement.



IP67

#### FEATURES

- Capacities 200N and 500N.
- Stainless steel construction.
- Environmental protection IP67.

#### APPLICATIONS

- Force and weight measurement.

#### OUTLINE DIMENSIONS

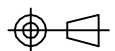
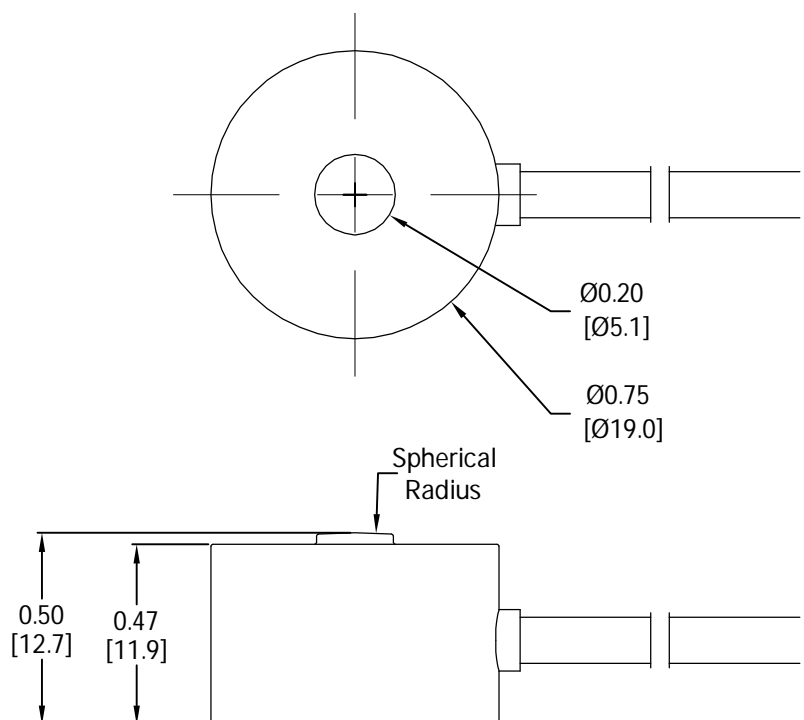

load button

# GBL 5035



## WIRING

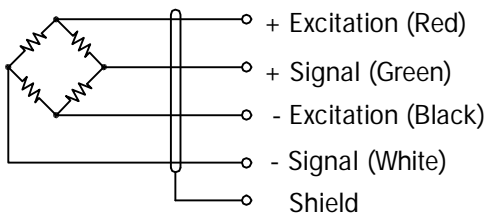

Cable: 28 AWG, 4 Core braided shield pvc gray cable.

## SPECIFICATIONS

Model	GBL		
Capacities	SEE TABLE		
Full Scale Output (FS)	mV/V		1±0.15
Non-Linearity	%FS		≤±0.5
Hysteresis	%FS		≤±0.5
Non- Repeatability	%FS		≤±0.5
Creep @ 5min	%FS		≤±0.5
Zero Balance	%FS		≤±2
Temperature Effect			
	Output	%FS/10°C	≤±0.04
	Zero	%FS/10°C	≤±0.04
Temperature Range			
	Compensated	°C	-10... +40
	Operating	°C	-10... +65
Terminal Resistance			
	Input Resistance	Ω	350±50
	Output Resistance	Ω	350±50
Excitation Voltage	VDC		5... 15
Insulation Resistance @ 50V DC	MΩ		≥5000
Safe Overload Limit	%FS		150
Cable Length	m		1.5
Seal Type	IP67		
Element Material	Stainless steel		

## PART NUMBERS

Capacity (N)	Part #
200	5035-000-00
500	5035-001-00

Dimensions and specifications subject to change without notice